



MASONITE®



## INTERIOR DOOR

Selection Guide





# Introducing Bayshore

## TRADITIONAL LINES, MODERN-DAY ENGINEERING

The molded panel Heritage Series® Bayshore 5-Panel Door seamlessly blends innovative design with contemporary style, effortlessly complementing any decor. Unlike traditional shaker-style doors with a typical panel profile angle of 90 degrees, our Bayshore features a distinctive panel profile angle that reduces dust accumulation in hard-to-reach corners and minimizing paint build-up, thereby simplifying the painting process.

- Solid core door is made with more sound-dampening material than our standard hollow core door for better sound control.
- Constructed with more material to better resist warping, shrinking, and cracking.
- More substantial than hollow core doors, our solid core doors have quality and strength you can feel.
- Available as a fire-rated door.
- Available as an ADA door.



46033-19



MASONITE®



Masonite is built on a 100-year history of innovation and sustainability. We proudly manufacture our doors using renewable natural resources to be better stewards of our planet. We thoughtfully design our selection and purchase processes to provide a best-in-class customer experience. We strive to deliver on these promises — every time.

We are on a mission to make life better as we elevate the “everyday door” into something extraordinary. We create beautiful, durable exterior and interior Doors That Do More™ in a curated portfolio that fulfills human needs for comfort, safety, security, and convenience so that people can rest, learn, work, and live more comfortably.

As we enter our next century, we will continue to ask what more can our doors do to make life better?

- 1 New — Bayshore
- 5 The Solid Core Difference
- 10 Interior Door Collections
- 14 Heritage Series®
- 16 West End Collection®
- 18 Molded Panel Series
- 22 Flush Series
- 24 Wood Doors





# The Solid Core Difference

Solid core interior doors are made with 70% more material than our standard hollow core doors, providing premium quality you can feel when opening and closing them.

70%  
more

sound-dampening material  
than our standard hollow core doors



**MASONITE  
HOLLOW CORE DOORS**

5-YEAR WARRANTY



**MASONITE  
SOLID CORE DOORS**

7-YEAR WARRANTY

Our solid core doors are made with more recycled material than our standard hollow core doors, too, for more mindful utilization of resources. And they're built to last — backed by a 7-year limited warranty.

These stronger, heavier doors enhance durability throughout a home. And their added density means they also reduce the transmission of noise, allowing you to keep the sound made in one room out of others.

# Make Solid Core The Standard

## Doors Designed to Be Different

We know that homes take a beating — and that they can be noisy too, which is why our durable, sound-dampening solid core doors are built for real life. Set a new standard with solid core, a sound-dampening solution that reflects the quality of the homes you build. These interior doors are more durable and less likely to warp over time, resulting in fewer callbacks. Homeowners will be able to see — and feel — the difference.

SOUND + PRIVACY + QUALITY

## The **Premium** Home Standard

Build consistency throughout the home with high-quality doors that look great and feel substantial.

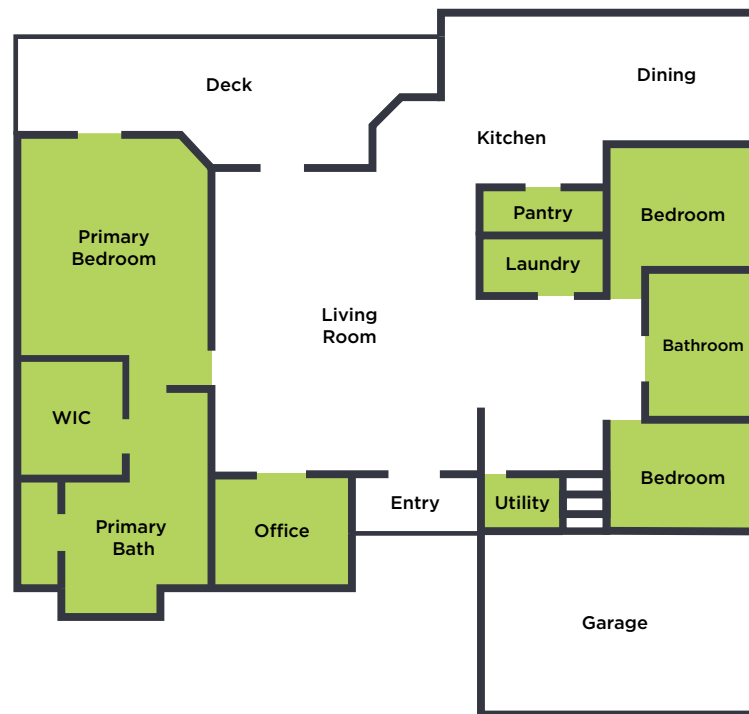

### Areas to consider:

- Bathrooms
- Bedrooms
- Closets
- Utility Room
- Laundry Room
- Home Office
- Pantry
- Media/Game Room



## The Step-Up Home Standard

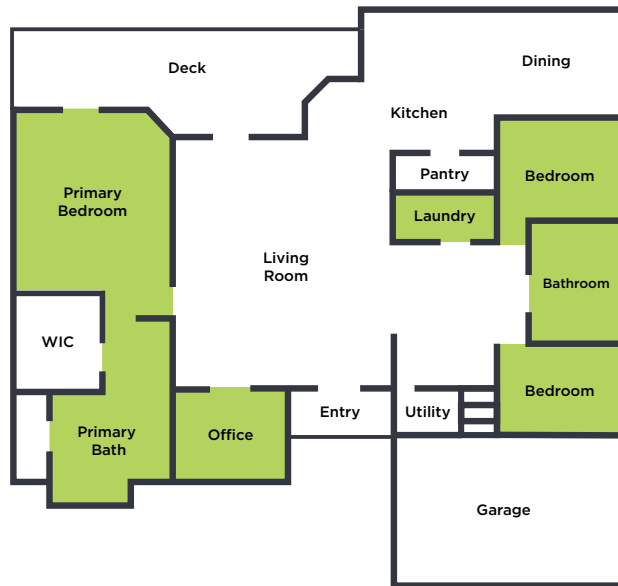

### SOUND + PRIVACY

Create quieter spaces for work and rest by using solid core doors to keep sound out of rooms. They enhance privacy as well.

#### AREAS TO CONSIDER:

**Bathrooms**  
**Laundry Room**  
**Bedrooms**  
**Home Office**

## The Starter Home Standard

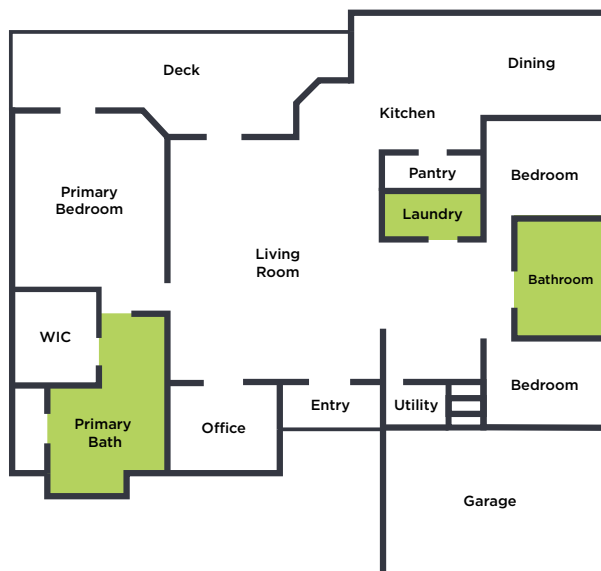

### SOUND

Install solid core doors to keep sound contained in some of the noisiest rooms of the house. Solid core also adds quality and durability to high-traffic areas.

#### AREAS TO CONSIDER:

**Bathrooms**  
**Laundry Room**

# Masonite Door Formats

Discover a range of interior door formats that offer style, function, and flexibility for every space.



## Hinge/Swing Doors

Standard door swing



## French/Double

Single or double door swing



## Bifold Doors

Space-saving option | Commonly used in closets



## Bypass

Space-saving option | Commonly used in closets



## Pocket Doors

Space-saving option | Requires hardware and space in the wall



## Barn Doors

Space-saving option | Sliding interior doors



# Masonite Interior Door Collections

Explore our extensive offerings of interior doors, crafted to meet your specific needs and design preferences. Whether you aim to reduce noise, increase light, or elevate style, our interior doors are designed to complement your home's unique design. Combining quality and versatility, our portfolio features meticulously designed styles that enhance and harmonize with any aesthetic, ensuring both functionality and timeless appeal.

## Heritage Series®

Page 7

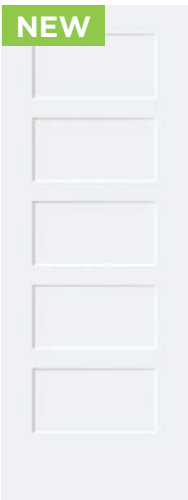

Bayshore  
\*



Lincoln Park®



Logan®



Winslow®



Berkley®

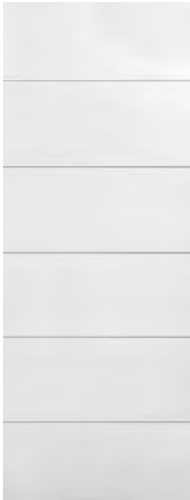

Melrose®

## West End Collection®

Page 13

## Molded Panel Series

Page 7



2-Panel Square



2-Panel Roman



2-Panel Arch-top



Cheyenne®



Livingston®



4-Panel

Flush Series

Page 13

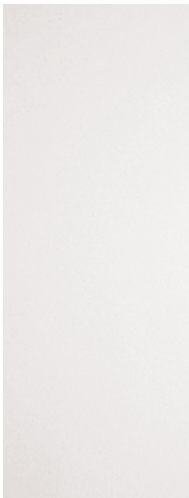

Primed Hardwood



Birch



Hardwood



Oak



Custom Options

Wood

Page 13



6-Panel



Riverside\*

\*AVAILABLE IN SOLID CORE

# Masonite Interior Door Collections



**Heritage Series®**  
Shaker Profile



**West End Collection®**  
Embossed Profile



**Molded Panel Series**  
Ovolo Profile



**Flush Doors**  
Flush Veneer





**Livingston®**



**Square Sticking Flat Panel**



**Ovolo Sticking Double Hip**



**Ovolo Sticking Single Hip**

# Heritage Series®



Craftsman-style features clean, straight lines with artisanal details and recessed panels. Their versatile design enhances the architectural appeal of any home, complementing both classic and contemporary aesthetics.

Lincoln Park®



Logan®



Winslow®



Bayshore



**\*AVAILABLE IN SOLID CORE**



# West End Collection®

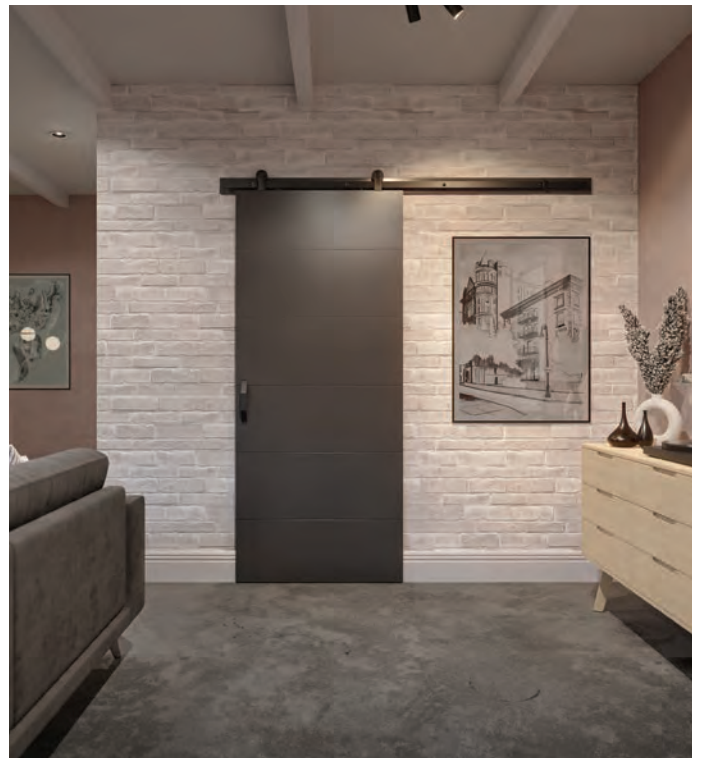

Modern homes reject excess and focus on purposeful minimalism. Throughout these crisp, uncluttered spaces, doors make simple yet bold design statements.

Berkley®



Melrose®



**\*AVAILABLE IN SOLID CORE**

# Molded Panel Series





Homes that transcend eras to create the ultimate mix of style and comfort can be paired with these doors to unify spaces and complement key details.

2-Panel Square

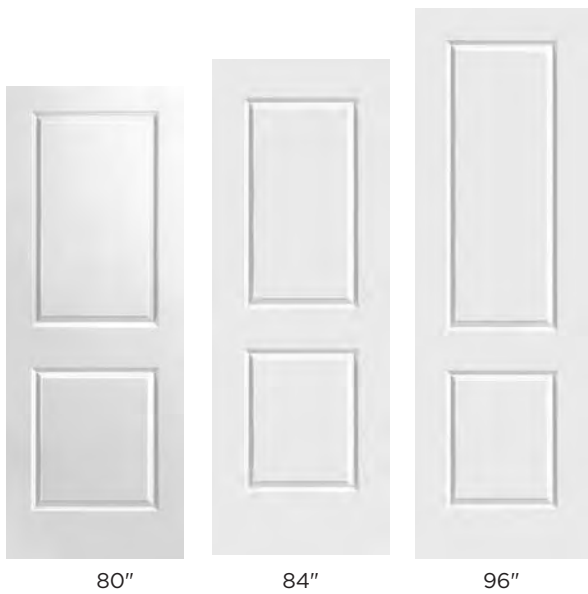

2-Panel Roman

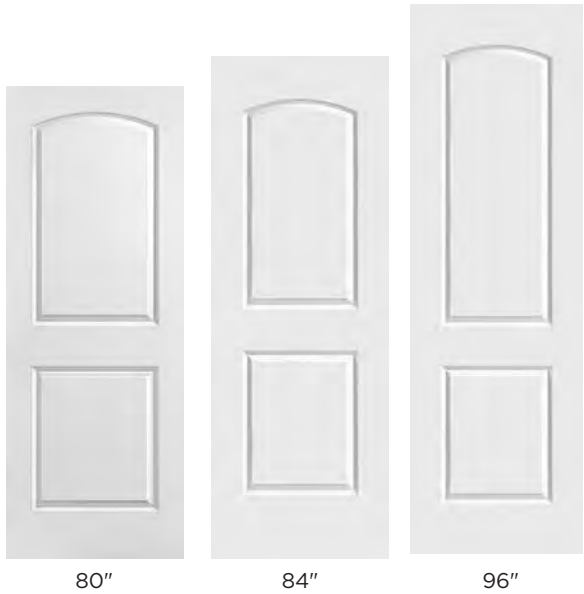

2-Panel Arch-Top



Cheyenne® 2-Panel Plank



**\*AVAILABLE IN SOLID CORE**

## Molded Panel Series

---



Classic and traditional homes are renowned for beauty and symmetry. These homes are often arranged around unique focal points with doors serving as defining architectural statements.

Livingston® 3-Panel Equal



4-Panel

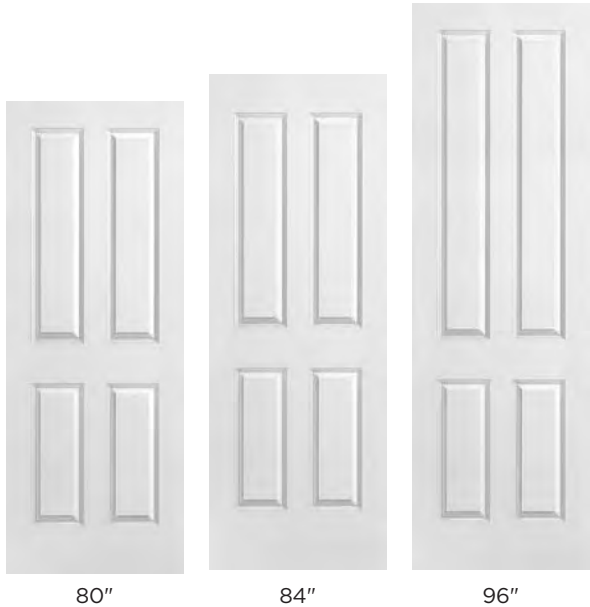

6-Panel

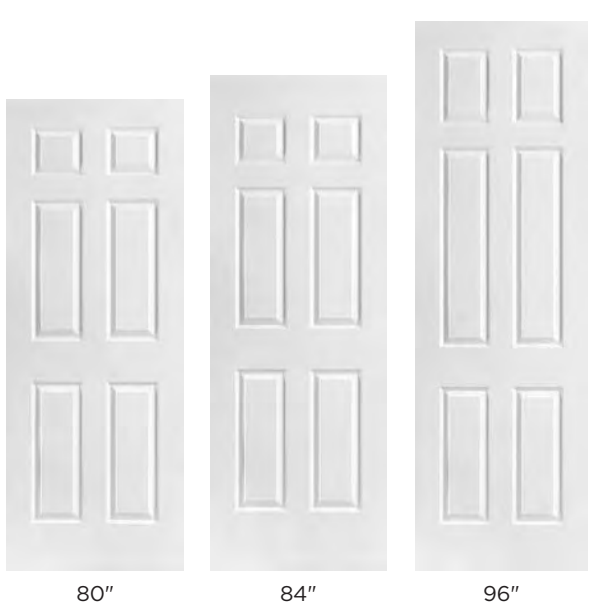

Riverside®

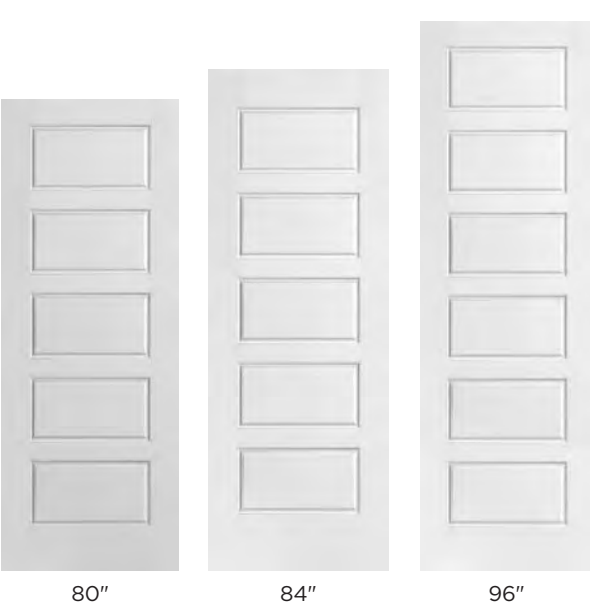

**\*AVAILABLE IN SOLID CORE**



# Masonite Flush Series





Flush doors offer a sleek, minimalist look with their smooth, flat surfaces, making them a versatile choice for contemporary spaces.

Primed Hardwood

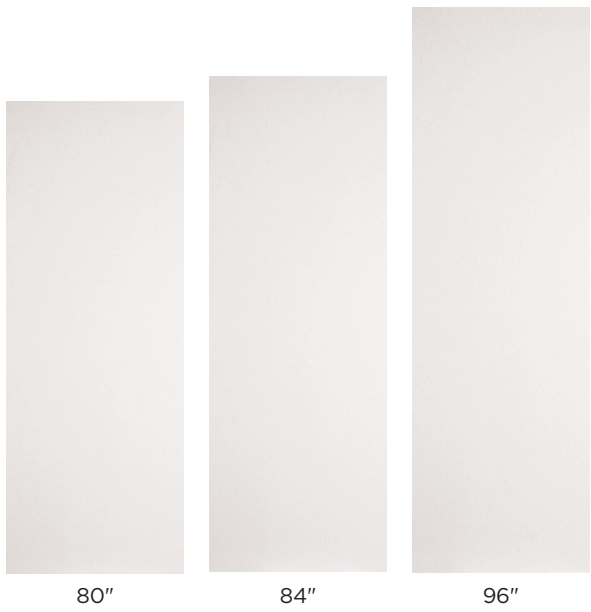

Birch



Hardwood

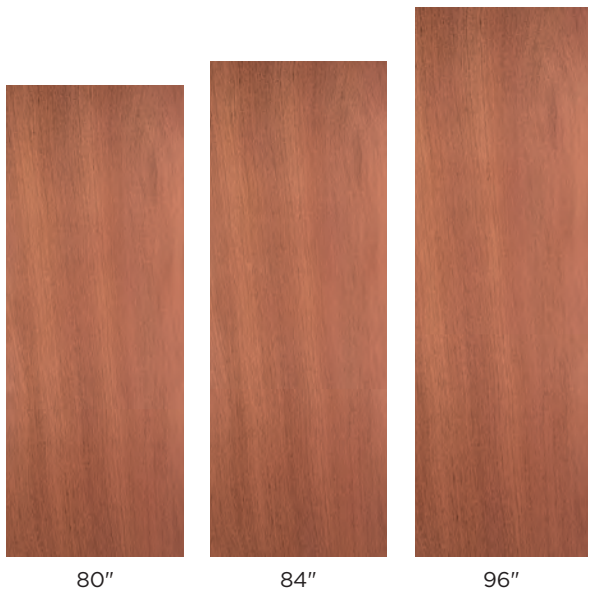

Oak

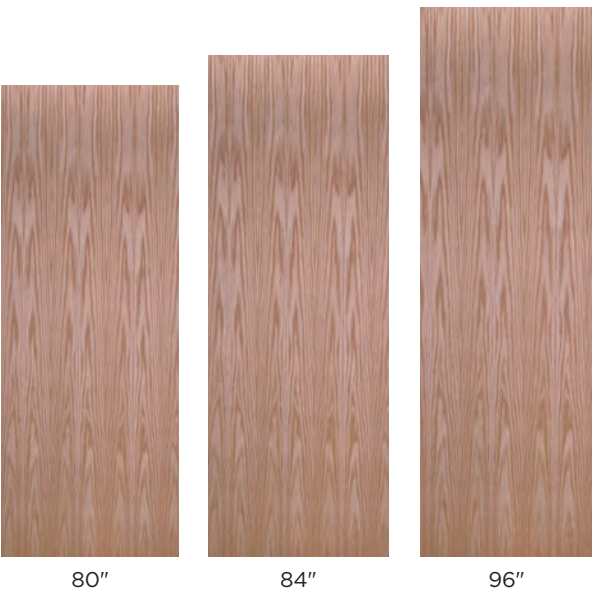

**\*AVAILABLE IN SOLID CORE**

# Masonite Interior Wood Doors





C30WG



C55WG



1501

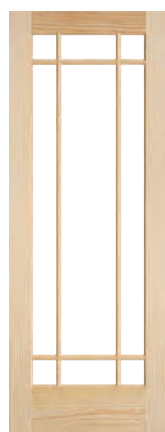

1509



1510



1510A



1515



1515C



2081



2082



501



521



512



2612



2641



2642



C22



C33



C35



C55



C66

A selection of our wood door options is shown.

To see all of our wood door options, please visit [masonite.com/wooddoors](http://masonite.com/wooddoors).



# Wood Options

From the rich elegance of walnut to the rustic charm of knotty pine, we have the wood species to achieve the look that defines your style. Choose from 19 stain-grade species or expand your options by having your door primed and ready to paint.







MAPLE



CLEAR  
ALDER



HEMLOCK



PINE



MAHOGANY



FIR



FIR  
TORREFIED



NOTTY  
ALDER



MAPLE  
TORREFIED

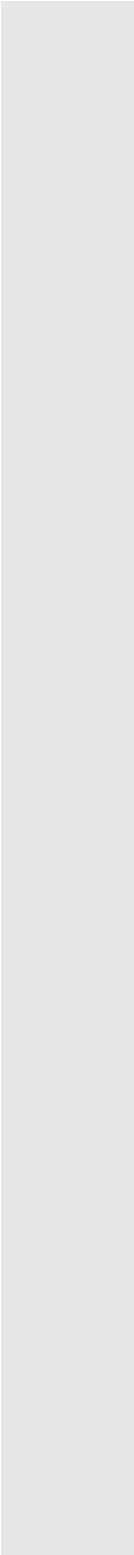

PRIMED

# Glass Options

Crystal-clear, opaque, patterned or plain, the glass you choose should be a reflection of your personal taste. We offer the widest array of glazing options in the industry, making it easy to achieve the look and level of privacy you desire.



Clear



Grey Tint\*



Flemish



Warwick



Waterglass\*



Morisco



Everglade



Master Carré\*



Rain



Classic Aquatex



Hammered



Glue Chip



Narrow Reed



Mayflower

Many designs are available with beveling, insulated glass (ig) and low-e options.



Bamboo\*



Obscure (Pinhead)



Satin Etched (Pearl.)



Delta Frost



Austin



Screen\*



Frosted



White Laminate\*



Mirror\*

## PRIVACY RATING GUIDE

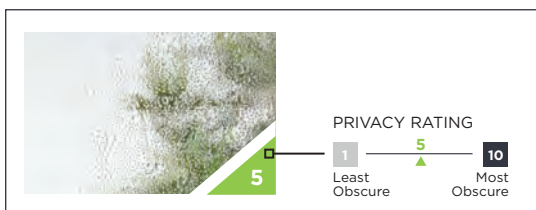

## Theme Availability

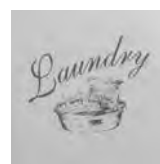

Laundry























Pantry





Wine Cellar

# Design and Size Options

## Molded Panel

| HERITAGE SERIES. *ADA                                                             |               |   | PASSAGE                                                                              |                                                                                     |     |     |     |     |     |     |     |     |     |     |     | BIFOLDS |     |     |     |     |     |     |     |   |
|-----------------------------------------------------------------------------------|---------------|---|--------------------------------------------------------------------------------------|-------------------------------------------------------------------------------------|-----|-----|-----|-----|-----|-----|-----|-----|-----|-----|-----|---------|-----|-----|-----|-----|-----|-----|-----|---|
|                                                                                   |               |   | 12"                                                                                  | 14"                                                                                 | 15" | 16" | 18" | 20" | 24" | 26" | 28" | 30" | 32" | 34" | 36" | 24"     | 28" | 30" | 32" | 36" | 48" | 60" | 72" |   |
|  | LINCOLN PARK. |   |                                                                                      |                                                                                     |     |     |     |     |     |     |     |     |     |     |     |         |     |     |     |     |     |     |     |   |
|                                                                                   | 80"           | • |  †▲ | •                                                                                   | •   | •   | •   | •   | •   | •   | •   | •   | •   | •   | •   | •       | •   |     | •   |     | •   | •   | •   | • |
|                                                                                   | 84"           | • |  †▲ | •                                                                                   | •   | •   | •   | •   | •   | •   | •   | •   | •   | •   | •   | •       | •   | •   | •   |     | •   | •   | •   | • |
|                                                                                   | 96"           | • |  †▲ | •                                                                                   | •   | •   | •   | •   | •   | •   | •   | •   | •   | •   | •   | •       | •   | •   | •   | •   |     | •   | •   | • |
|  | LOGAN.        |   |                                                                                      |                                                                                     |     |     |     |     |     |     |     |     |     |     |     |         |     |     |     |     |     |     |     |   |
|                                                                                   | 80"           | • |  †▲ |  ▲ | •   | •   | •   | •   | •   | •   | •   | •   | •   | •   | •   | •       | •   | •   |     | •   |     | •   | •   | • |
|                                                                                   | 84"           | • |  †▲ |  ▲ | •   | •   | •   | •   | •   | •   | •   | •   | •   | •   | •   | •       | •   | •   | •   |     | •   |     | •   | • |
|                                                                                   | 96"           | • |  †▲ |  ▲ | •   | •   | •   | •   | •   | •   | •   | •   | •   | •   | •   | •       | •   | •   | •   |     | •   |     | •   | • |
|  | WINSLOW.      |   |                                                                                      |                                                                                     |     |     |     |     |     |     |     |     |     |     |     |         |     |     |     |     |     |     |     |   |
|                                                                                   | 80"           | • |  †▲ | •                                                                                   | •   | •   | •   | •   | •   | •   | •   | •   | •   | •   | •   | •       | •   | •   |     | •   |     | •   | •   | • |
|                                                                                   | 84"           | • |  †▲ | •                                                                                   | •   | •   | •   | •   | •   | •   | •   | •   | •   | •   | •   | •       | •   | •   | •   |     | •   |     | •   | • |
|  | BAYSHORE      |   |                                                                                      |                                                                                     |     |     |     |     |     |     |     |     |     |     |     |         |     |     |     |     |     |     |     |   |
|                                                                                   | 80"           | • |  †▲ |  ▲ | •   | •   | •   | •   | •   | •   | •   | •   | •   | •   | •   | •       | •   | •   |     | •   |     | •   | •   | • |
|                                                                                   | 84"           | • |  †▲ |  ▲ | •   | •   | •   | •   | •   | •   | •   | •   | •   | •   | •   | •       | •   | •   | •   |     | •   |     | •   | • |
|                                                                                   | 96"           | • |  †▲ |  ▲ | •   | •   | •   | •   | •   | •   | •   | •   | •   | •   | •   | •       | •   | •   | •   |     | •   |     | •   | • |

|                                                                                     |          |   | PASSAGE |     |     |     |     |     |     |     |     |     |     |     | BIFOLDS |     |     |     |     |     |     |     |     |
|-------------------------------------------------------------------------------------|----------|---|---------|-----|-----|-----|-----|-----|-----|-----|-----|-----|-----|-----|---------|-----|-----|-----|-----|-----|-----|-----|-----|
| WEST END COLLECTION. *ADA                                                           |          |   | 12"     | 14" | 15" | 16" | 18" | 20" | 24" | 26" | 28" | 30" | 32" | 34" | 36"     | 24" | 28" | 30" | 32" | 36" | 48" | 60" | 72" |
|  | BERKLEY. |   |         |     |     |     |     |     |     |     |     |     |     |     |         |     |     |     |     |     |     |     |     |
|                                                                                     | 80"      | • | •       | •   | •   | •   | •   | •   | •   | •   | •   | •   | •   | •   | •       | •   |     | •   |     | •   |     |     |     |
|                                                                                     | 84"      | • | •       | •   | •   | •   | •   | •   | •   | •   | •   | •   | •   | •   | •       | •   | •   |     | •   |     | •   |     |     |
|  | MELROSE. |   |         |     |     |     |     |     |     |     |     |     |     |     |         |     |     |     |     |     |     |     |     |
|                                                                                     | 80"      | • | •       | •   | •   | •   | •   | •   | •   | •   | •   | •   | •   | •   | •       | •   |     | •   |     | •   |     |     |     |
|                                                                                     | 84"      | • | •       | •   | •   | •   | •   | •   | •   | •   | •   | •   | •   | •   | •       | •   | •   |     | •   |     | •   |     |     |

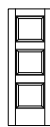
|                                                                                     |             |   | PASSAGE |     |     |     |     |     |     |     |     |     |     |     | BIFOLDS |     |     |     |     |     |     |     |     |
|-------------------------------------------------------------------------------------|-------------|---|---------|-----|-----|-----|-----|-----|-----|-----|-----|-----|-----|-----|---------|-----|-----|-----|-----|-----|-----|-----|-----|
| MOLDED PANEL SERIES *ADA                                                            |             |   | 12"     | 14" | 15" | 16" | 18" | 20" | 24" | 26" | 28" | 30" | 32" | 34" | 36"     | 24" | 28" | 30" | 32" | 36" | 48" | 60" | 72" |
|  | LIVINGSTON. |   |         |     |     |     |     |     |     |     |     |     |     |     |         |     |     |     |     |     |     |     |     |
|                                                                                     | 80"         | • | •†▲     | •   | •   | •   | •   | •   | •   | •   | •   | •   | •   | •   | •       | •   |     | •   |     | •   | •   | •   | •   |
|                                                                                     | 84"         | • | •†▲     | •   | •   | •   | •   | •   | •   | •   | •   | •   | •   | •   | •       | •   | •   |     | •   |     | •   | •   | •   |
|                                                                                     | 96"         | • | •†▲     | •   | •   | •   | •   | •   | •   | •   | •   | •   | •   | •   | •       | •   | •   |     | •   |     | •   | •   | •   |

\* ADA compliant 10" bottom rail.

† Standard bore machining (2-1/8" diameter) requires a stile no less than **3-11/16"** to accommodate a **2-3/8" backset**.

▲ Standard bore machining (2-1/8" diameter) requires a stile no less than **4-1/16"** to accommodate a **2-3/4" backset**.







\*\*Narrow outside stile could restrict handle set options.

Note: 48", 60" and 72" bifolds are achieved by doubled 24", 30" and 36" bifolds (has 4 pieces).

Note: West End Collection is not for use with double doors.

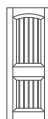
Please note that some sizes are only available as a result of being trimmed from a larger facing. The trimming process may result in a stile width that is too narrow to accommodate a standard bore. To machine a standard bore with a 2-3/8" backset on the lock hole and a 2-1/8" diameter bore, the outer stile measurements must be no less than 3-7/16" wide. Many facings have a lockrail that will accommodate a standard bore even when the stile width is too narrow. Please refer to Masonite Molded Door Facing Dimensional Specifications to verify the outer stile measurements or contact your Masonite Interior Door servicing plant. Textured refers to embossed wood-grain. Pre-finished white is available as textured only. Not all molded panel designs and sizes are available in all regions as stock products. Please check for special order availability. Our continuing program of product improvement makes specification, design, and product detail subject to change without notice.



| MOLDED PANEL SERIES                                                                 |                    |  | *ADA | PASSAGE |     |     |     |     |     |     |     |     |     |     |     |     |     | BIFOLDS |     |     |     |     |     |     |  |
|-------------------------------------------------------------------------------------|--------------------|--|------|---------|-----|-----|-----|-----|-----|-----|-----|-----|-----|-----|-----|-----|-----|---------|-----|-----|-----|-----|-----|-----|--|
|                                                                                     |                    |  |      | 12"     | 14" | 15" | 16" | 18" | 20" | 24" | 26" | 28" | 30" | 32" | 34" | 36" | 24" | 28"     | 30" | 32" | 36" | 48" | 60" | 72" |  |
|    | 2-PANEL ARCH-TOP   |  |      |         |     |     |     |     |     |     |     |     |     |     |     |     |     |         |     |     |     |     |     |     |  |
|                                                                                     | Textured 80"       |  |      | ●+▲     | ●▲  | ●▲  | ●   | ●   | ●   | ●   | ●   | ●   | ●   | ●   | ●   | ●   | ●   | ●       | ●   | ●   | ●   | ●   | ●   | ●   |  |
|    | 2-PANEL ROMAN      |  |      |         |     |     |     |     |     |     |     |     |     |     |     |     |     |         |     |     |     |     |     |     |  |
|                                                                                     | 80"                |  |      | ●+▲     | ●▲  | ●▲  | ●   | ●+▲ | ●▲  | ●   | ●   | ●   | ●   | ●   | ●   | ●   | ●   | ●       | ●   | ●   | ●   | ●   | ●   | ●   |  |
|                                                                                     | 84"                |  | ●    | ●+▲     | ●▲  | ●▲  | ●   | ●+▲ | ●▲  | ●   | ●   | ●   | ●   | ●   | ●   | ●   | ●   | ●       | ●   | ●   | ●   | ●   | ●   | ●   |  |
|                                                                                     | 96"                |  |      |         |     |     | ●+▲ | ●▲  | ●   | ●   | ●   | ●   | ●   | ●   | ●   | ●   | ●   |         |     | ●   | ●   | ●   | ●   | ●   |  |
|    | 2-PANEL            |  |      |         |     |     |     |     |     |     |     |     |     |     |     |     |     |         |     |     |     |     |     |     |  |
|                                                                                     | 80"                |  |      | ●+▲     | ●▲  | ●▲  | ●   | ●+▲ | ●▲  | ●   | ●   | ●   | ●   | ●   | ●   | ●   | ●   | ●       | ●   | ●   | ●   | ●   | ●   | ●   |  |
|                                                                                     | 84"                |  | ●    | ●+▲     | ●▲  | ●▲  | ●   | ●+▲ | ●▲  | ●   | ●   | ●   | ●   | ●   | ●   | ●   | ●   | ●       | ●   | ●   | ●   | ●   | ●   | ●   |  |
|                                                                                     | 96"                |  |      | ●+▲     | ●▲  | ●▲  | ●   | ●+▲ | ●▲  | ●   | ●   | ●   | ●   | ●   | ●   | ●   | ●   | ●       | ●   | ●   | ●   | ●   | ●   | ●   |  |
|                                                                                     | CHEYENNE           |  |      |         |     |     |     |     |     |     |     |     |     |     |     |     |     |         |     |     |     |     |     |     |  |
|                                                                                     | 80"                |  |      | ●+▲     | ●+▲ | ●▲  | ●   | ●+▲ | ●   | ●   | ●   | ●   | ●   | ●   | ●   | ●   | ●   | ●       | ●   | ●   | ●   | ●   | ●   | ●   |  |
|    | 96"                |  |      | ●+▲     | ●+▲ | ●▲  | ●   | ●+▲ | ●   | ●   | ●   | ●   | ●   | ●   | ●   | ●   | ●   | ●       | ●   | ●   | ●   | ●   | ●   | ●   |  |
|                                                                                     | RIVERSIDE          |  |      |         |     |     |     |     |     |     |     |     |     |     |     |     |     |         |     |     |     |     |     |     |  |
|                                                                                     | 80"                |  |      | ●+▲     | ●   | ●   | ●   | ●   | ●   | ●   | ●   | ●   | ●   | ●   | ●   | ●   | ●   | ●       | ●   | ●   | ●   | ●   | ●   | ●   |  |
|   | 84"                |  | ●    | ●+▲     | ●   | ●   | ●   | ●   | ●   | ●   | ●   | ●   | ●   | ●   | ●   | ●   | ●   | ●       | ●   | ●   | ●   | ●   | ●   | ●   |  |
|                                                                                     | 96"                |  |      | ●+▲     | ●   | ●   | ●   | ●   | ●   | ●   | ●   | ●   | ●   | ●   | ●   | ●   | ●   | ●       | ●   | ●   | ●   | ●   | ●   | ●   |  |
|                                                                                     | 4-PANEL            |  |      |         |     |     |     |     |     |     |     |     |     |     |     |     |     |         |     |     |     |     |     |     |  |
|  | 80"                |  |      | ●+▲     | ●▲  | ●▲  | ●   | ●+▲ | ●▲  | ●   | ●   | ●   | ●   | ●   | ●   | ●   | ●   | ●       | ●   | ●   | ●   | ●   | ●   | ●   |  |
|                                                                                     | 84"                |  | ●    | ●+▲     | ●▲  | ●▲  | ●   | ●+▲ | ●▲  | ●   | ●   | ●   | ●   | ●   | ●   | ●   | ●   | ●       | ●   | ●   | ●   | ●   | ●   | ●   |  |
|                                                                                     | 96"                |  |      | ●+▲     | ●▲  | ●▲  | ●   | ●+▲ | ●▲  | ●   | ●   | ●   | ●   | ●   | ●   | ●   | ●   | ●       | ●   | ●   | ●   | ●   | ●   | ●   |  |
|  | 6-PANEL            |  |      |         |     |     |     |     |     |     |     |     |     |     |     |     |     |         |     |     |     |     |     |     |  |
|                                                                                     | 80"                |  |      | ●+▲     | ●▲  | ●▲  | ●   | ●+▲ | ●▲  | ●   | ●   | ●   | ●   | ●   | ●   | ●   | ●   | ●       | ●   | ●   | ●   | ●   | ●   | ●   |  |
|                                                                                     | 84"                |  | ●    | ●+▲     | ●▲  | ●▲  | ●   | ●+▲ | ●▲  | ●   | ●   | ●   | ●   | ●   | ●   | ●   | ●   | ●       | ●   | ●   | ●   | ●   | ●   | ●   |  |
|                                                                                     | 96"                |  |      | ●+▲     | ●▲  | ●▲  | ●   | ●+▲ | ●▲  | ●   | ●   | ●   | ●   | ●   | ●   | ●   | ●   | ●       | ●   | ●   | ●   | ●   | ●   | ●   |  |
|                                                                                     | Textured 80"       |  |      | ●+▲     | ●▲  | ●▲  | ●   | ●+▲ | ●▲  | ●   | ●   | ●   | ●   | ●   | ●   | ●   | ●   | ●       | ●   | ●   | ●   | ●   | ●   | ●   |  |
|                                                                                     | Textured 84"       |  | ●    |         |     |     |     |     |     | ●   | ●   | ●   | ●   | ●   | ●   | ●   | ●   | ●       | ●   | ●   | ●   | ●   | ●   | ●   |  |
|                                                                                     | Textured 96"       |  |      |         |     |     |     |     |     | ●   | ●   | ●   | ●   | ●   | ●   | ●   | ●   | ●       | ●   | ●   | ●   | ●   | ●   | ●   |  |
|  | 2-PANEL COMMERCIAL |  |      |         |     |     |     |     |     |     |     |     |     |     |     |     |     |         |     |     |     |     |     |     |  |
|                                                                                     | 80"                |  | ●    |         |     |     |     |     |     |     |     |     |     | ●   | ●   | ●   | ●   |         |     |     |     |     |     |     |  |
|                                                                                     | 84"                |  | ●    |         |     |     |     |     |     |     |     |     |     | ●   | ●   | ●   | ●   |         |     |     |     |     |     |     |  |

| FLUSH SERIES                                                                        |                       |  |  | PASSAGE |     |     |     |     |     |     |     |     |     |     |     |     |     | BIFOLDS |     |     |     |     |     |     |  |
|-------------------------------------------------------------------------------------|-----------------------|--|--|---------|-----|-----|-----|-----|-----|-----|-----|-----|-----|-----|-----|-----|-----|---------|-----|-----|-----|-----|-----|-----|--|
|  | 80", 84", 96" Heights |  |  | 12"     | 14" | 15" | 16" | 18" | 20" | 24" | 26" | 28" | 30" | 32" | 34" | 36" | 24" | 28"     | 30" | 32" | 36" | 48" | 60" | 72" |  |
|                                                                                     | MDF                   |  |  |         |     |     |     |     |     |     |     |     |     |     |     |     |     |         |     |     |     |     |     |     |  |
|                                                                                     | Primed                |  |  | •       | •   | •   | •   | •   | •   | •   | •   | •   | •   | •   | •   | •   | •   | •       | •   | •   | •   | •   | •   |     |  |
|                                                                                     | VENEER                |  |  |         |     |     |     |     |     |     |     |     |     |     |     |     |     |         |     |     |     |     |     |     |  |
|                                                                                     | Oak, Birch, Hardwood  |  |  | •       | •   | •   | •   | •   | •   | •   | •   | •   | •   | •   | •   | •   | •   | •       | •   | •   | •   | •   | •   | •   |  |

# Panel and Sticking Options

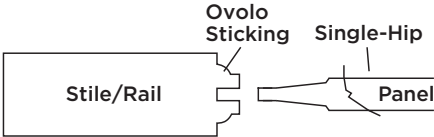
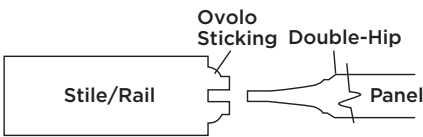
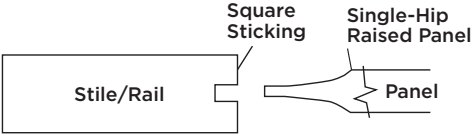
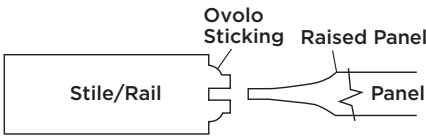
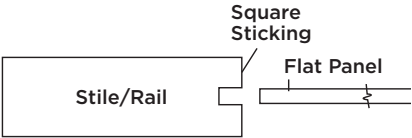
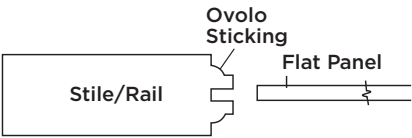

| PANEL STANDARDS  | 1-3/8" Door                        | 1-3/4" Door                                                         | Construction                                                     |
|------------------|------------------------------------|---------------------------------------------------------------------|------------------------------------------------------------------|
| Flat Panel       | standard: 1/2"<br>upgrades: 3/4"   | standard: 1/2"<br>upgrades: 3/4"                                    | standard: veneered *<br>upgrades: solid available<br>most models |
| Raised Panel     | standard: 3/4"<br>upgrades: 1-1/8" | standard (interior): 3/4"<br>standard (exterior) & upgrades: 1-1/8" | standard: veneered *<br>upgrades: solid available<br>most models |
| Single-Hip Panel | 9/16"                              | 9/16"                                                               | Solid                                                            |
| Double-Hip panel | standard: 3/4"<br>upgrades: 1-1/8" | standard (interior): 3/4"<br>standard (exterior) & upgrades: 1-1/8" | Solid                                                            |

\*Knotty Alder standard is solid and not available in raised panel

# Design Details

## DOOR TOPS

Complement your home’s unique architectural details with distinct door tops. Choose from straight-top, semi-circular or arched-top options.

**\*NOTE:** Round-round and half-round round are not available in Torrefied.

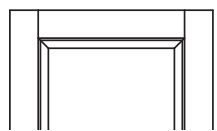

STANDARD

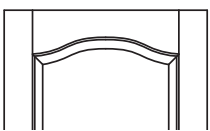

CLASSIQUE

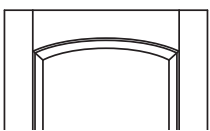

ARCH



SEGMENT

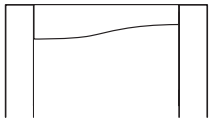

HALF CLASSIQUE



HALF-ARCH

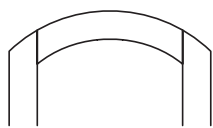

ARCH-ARCH

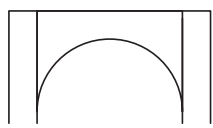

ROUND

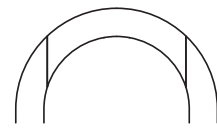

ROUND-ROUND\*

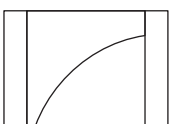

HALF-ROUND

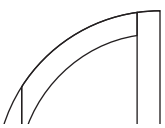

HALF-ROUND ROUND\*

## INTERIOR JAMBS & EXTERIOR FRAMES



DOUBLE-RABBET JAMB  
(4 9/16" & 6 9/16")



SINGLE-RABBET JAMB  
(4 9/16" & 6 9/16")



FLAT JAMB  
(4 9/16" & 6 9/16")

| JAMB OPTIONS      | All Square Tops<br>(Arch, Half-arch, Classique, Half Classique and Round top rails) | All Rounded Tops<br>(Segment, Arch-arch, Round-round, Half-round top rails) |
|-------------------|-------------------------------------------------------------------------------------|-----------------------------------------------------------------------------|
| Torrefied         | All                                                                                 | Segment, Arch-arch and Half round-top                                       |
| Mahogany          | Heads and legs available                                                            | All                                                                         |
| All Other Species | No                                                                                  | All                                                                         |
| Fire-Rated        | All                                                                                 | All                                                                         |



[masonite.com](https://masonite.com)